



advanced

fire protection solutions

for modern applications



in Control

Systems Inc.

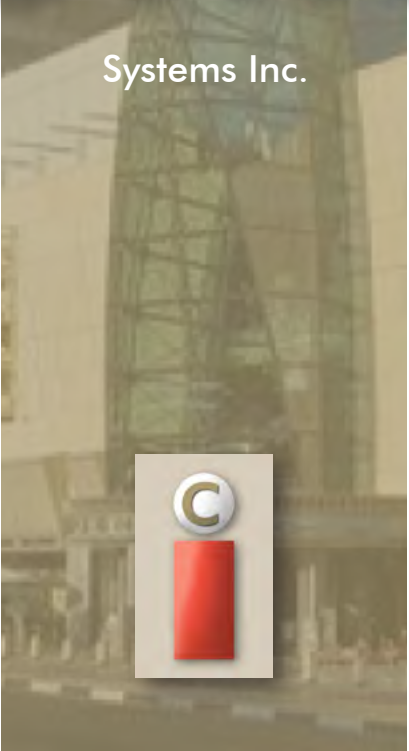

When it comes to fire protection, nothing can be left to chance. That's why

since 1984 consultants and engineers around the world have been specifying inControl Systems as their fire protection solutions of choice. It's not surprising: with advanced features that save time and money, and patented innovations that raise the standard for

reliability, inControl has proven time and time again that real value is in the details.

Left: precision-made assemblies listed for use with clean agent leave nothing to chance.

Clean Agent

Details like 100 percent precision machined valves for unparalleled reliability, and ingenious back pressure operation that eliminates the need for costly pressurizing lines. Find out how to gain the competitive edge you need to succeed in the fire protection business. Contact your inControl representative today.

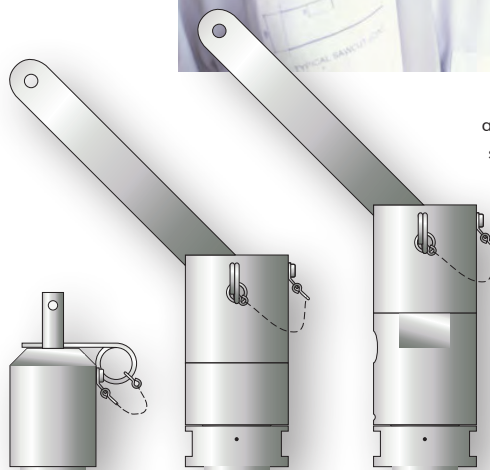

Below: A wide range of actuators offer the application flexibility you need to make every system installation successful and profitable.

Quality clean agent valves for mission-critical applications...

A generous selection of sizes means you can specify the valve best suited to your application.



inCONTROL

- **Engineered for fast operation** – generous discharge ports.
- **Machined brass construction for added reliability** – no forged parts.
- **High-performance operation** – clear flowpaths, low equivalent lengths.
- **Flexible application** – wide range of manual and electric actuators.
- **Ideal for:**
 - Computer and electrical rooms
 - Dry cleaning plants
 - Bank vaults and depositories
 - Museums and archives
 - Transformer vaults
 - Chemical and flammables storage
 - Engine compartments
 - Spray booths
 - Research laboratories
 - Records storage

Your single source for fire protection systems and equipment, from actuators and solenoids, to check valves and discharge bends.

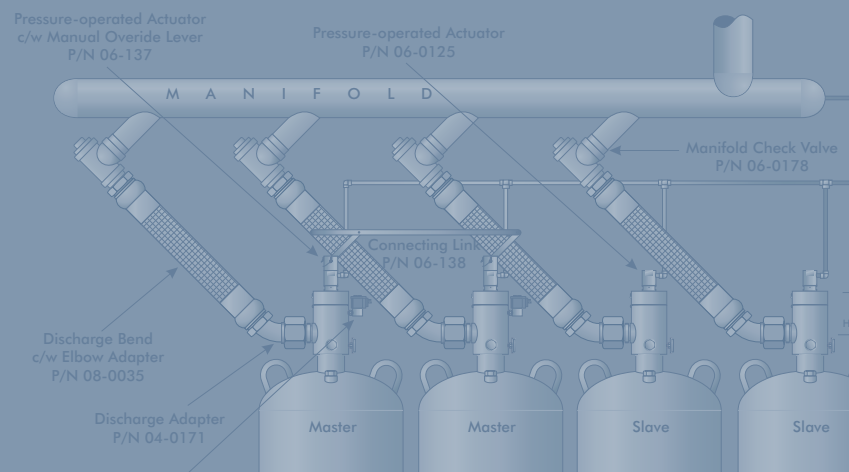

inControl's flagship SW-50 valves represent the pinnacle of high pressure carbon dioxide control and distribution technology today. The SW-50's exclusive patented unibody design does away with separate valve and discharge heads, which means there are no cap joints to leak or fail. Meanwhile, its ingenious force differential operation uses cylinder pressure to hold the valve closed, so slave valves can operate from manifold back pressure. This not only saves time and money, it also improves valve performance compared with conventional valves. In fact, these valves are so efficient that slave versions do not require a separate pressurizing line.

CO₂

high pressure

- **Patented cost-saving unibody design**
– does not have separate valve and discharge heads.
- **Engineered for reliability**
– no top or bottom cap joints to leak.
- **Simple to set up**
– slave valve operates from manifold back pressure ... no need for a separate pressurizing line.
- **Easy to maintain**
– removable valve seat for quick maintenance and service.
- **Ingenious force differential valve**
– uses cylinder pressure to hold the valve closed.
- **Machined brass construction**
– high quality, precision manufactured for superior reliability.



SW-50: Patented design offers exclusive features and cost-saving flexibility.

Field proven and cost-effective, inControl CO₂ systems offer a comprehensive fire protection solution for any size installation.



Right: for decades inControl CO₂ systems have been protecting property and assets worldwide.

Leading technology.
Innovative approaches.
Fresh opportunities.



inControl low pressure CO2

solutions offer space-saving designs for centralized indoor or outdoor storage and efficient spot flooding or site-wide distribution of CO2.

Especially well-suited to large applications, inControl low pressure CO2 systems provide cost-effective fire protection in applications of more than one tonne. Low-maintenance refrigerated storage tanks keep the CO2 at temperatures low enough for it to remain in a liquid state. This permits large quantities of CO2 to be stored safely and efficiently. Ideal where frequent discharges are expected, inControl low pressure CO2 storage vessels can be recharged on-site without taking the system offline.

low pressure
CO2

**Space-saving designs
for centralized indoor
or outdoor storage.**

Typical Applications Include:

- Power Plants
- Steel Mills
- Manufacturing Facilities
- Chemical Plants
- Metal Finishing Facilities
- Cargo ships
- Printing presses



Water

inControl Water Mist Systems offer safe, effective and environmentally benign fire suppression. High pressure systems operate at a working pressure of 100bar to 120bar with specially-designed discharge nozzles that spray water in tiny droplets. This results in a fog that provides a highly effective combination of extinguishing actions:

Cooling Action: The small size of the water particles causes them to evaporate quickly, removing a large amount of thermal energy.

Shielding Action: The particles of water absorb the radiant energy released by the fire, and significantly reduce the chance the fire will re-ignite.

Inerting Action: The water vapour acts like an inert agent and helps control and suppress the fire.

Specially engineered discharge nozzles designed to spray water in the form of an extinguishing fog

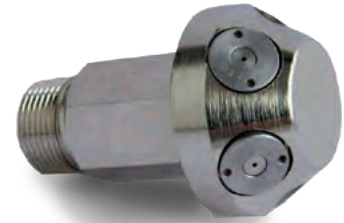

Advantages

- environmentally friendly
- minimizes the damage caused by the extinguishing agent
- safe for occupied spaces
- eliminates the cost of large water storage tanks and pumps

Applications

- machinery space, turbines, generators, off-shore platforms
- warehouses, shops, hotels, archives, libraries
- military, cruise and other ships



Foam

inControl High-Ex foam extinguishing systems provide economical fire protection and are particularly useful where there is a poor water supply or where no permanent water supply is available. They are self-contained and include reservoirs for water and for foam solution. Units are modular and can be customized for almost any type and size of hazard. Foam systems are factory built and tested allowing for fast on-site installation and commissioning. Each modular unit is designed to occupy the smallest possible area of valuable floor space. Explosion proof construction is available for hazardous areas. Units can be equipped with Programmable Logic Control (PLC), and remote monitoring is available for all functions.

Self-aspirating Foam Generators

inControl self-aspirating foam generators are meticulously designed with just the right shape, mesh screen size, and perforation frequency to efficiently combine water, foam solution, and air. With exceptionally high expansion ratios, these rugged units are prized as fire fighting measures, especially in remote areas and where access to water is limited. And, because they are self-aspirating, they deliver a highly accurate mix of solution, water, and air without the large pressure losses associated with in-line inductors. This not only reduces the required pump duty – it saves space as well.

Automatic

Stop Flames Cold.

inControl's Torrent Series automatic fire extinguishers act fast to knock down fires before they can take hold. With discharge times of 10 seconds or less, installations benefit from virtually instant response to the danger posed by fire.

Totally self-contained and fully automatic, these units require no external power or connections, yet they maintain fire protection around the clock, delivering years of reliable service. Installation takes just minutes, and relocation is easily accomplished to suit changing fire protection needs.

Torrent Series extinguishers use HFC-227ea: an effective clean agent that's approved for use in occupied spaces. HFC-227ea leaves no messy residue, and will not harm sensitive equipment. It's also approved by Environment Canada and the US Environmental Protection Agency as an acceptable Halon alternative.

Safe, effective, economical, and uncomplicated, these extinguishers are ideal either as part of a total fire protection package, or as an incremental upgrade to existing fire protection measures.

- **No damage or residue**
– protected area contents not affected by the extinguishing agent.
- **Simple one-person installation**
– no piping, electric wiring, special tools, or expertise necessary.
- **Fully automatic**
– 24/7 fire protection, anywhere.
- **Easy to maintain**
– integrated pressure gauge indicates fire protection status at a glance.
- **Ideal for marine use**
– essential in engine compartments of commercial vessels and pleasure craft.
- **Meets environmental regulations**
– complies with current standards for clean agent extinguishing systems.
- **People and pet friendly**
– listed for use in normally occupied spaces.

Integrated heat detector reacts instantly to fire conditions.

Accessory connections for pressure switch, discharge indicator, or manual operation.

On-board pressure gauge for added confidence.

Potent clean agent provides powerful, effective fire protection.



References

- West Coast Energy

- Trans Canada Power

- Newfoundland Power

- Lafarge, Manitoulin Island



- Meridien Hotel, Amman Jordan



- Sonatrach, Algeria

- Petrobras, Brazil

- Tengizchevroil Kazakstan

- Tenega Malaysia



- Qatar Liquefied Gas Company

- Petro Vietnam

- NAOC Nigeria Oil Company

- Federal Express Toronto



- CFB North Bay

- Danish Marine Authority

- Airport of Mar del Plata, Argentina

- Australia National Education Building

- Hospital de Traumatologia Valle Hebron, Spain

- Ministerio de Justicia, Spain

- New Tunnel, Hong Kong

- Ministry of Interior, Italy

- Ministry of Labour, Italy

- Ministry of Health, Italy

- Ministry of the Treasury, Italy

- National Library of Rome, Italy



- Kuwait Oil Company

- Samsung Electrics, South Korea

- National Commerical Bank, Saudi Arabia



- Thermax, India

Contact Us.

At inControl we know what you're up against.
We understand your business because we have the experience
and know-how that only comes from years of excellence in the fire protection industry.
Find out more. Contact your inControl representative today.

75 Shields Court, Unit #4, Markham, Ontario, Canada, L3R 9T4

Tel: + 1 905 415 0400

Email: inquiry@incontrolsystems.net

Website: www.inControlSystems.net



inControl
Systems Inc.